

# **THOMSON**

## **INSTRUCTION MANUAL**

### **STEAM IRON**



**MODEL: DR-2038A**

Thank you for purchasing our product. Before attempting to connect, operate or adjust this product, please read the instructions completely for safe and proper use of this product. Please save this operating manual for future reference.

## Technical Data

Model: **DR-2038A**  
Power supply: 230~ 60Hz  
Power input: 1100W Class I

## Know your iron

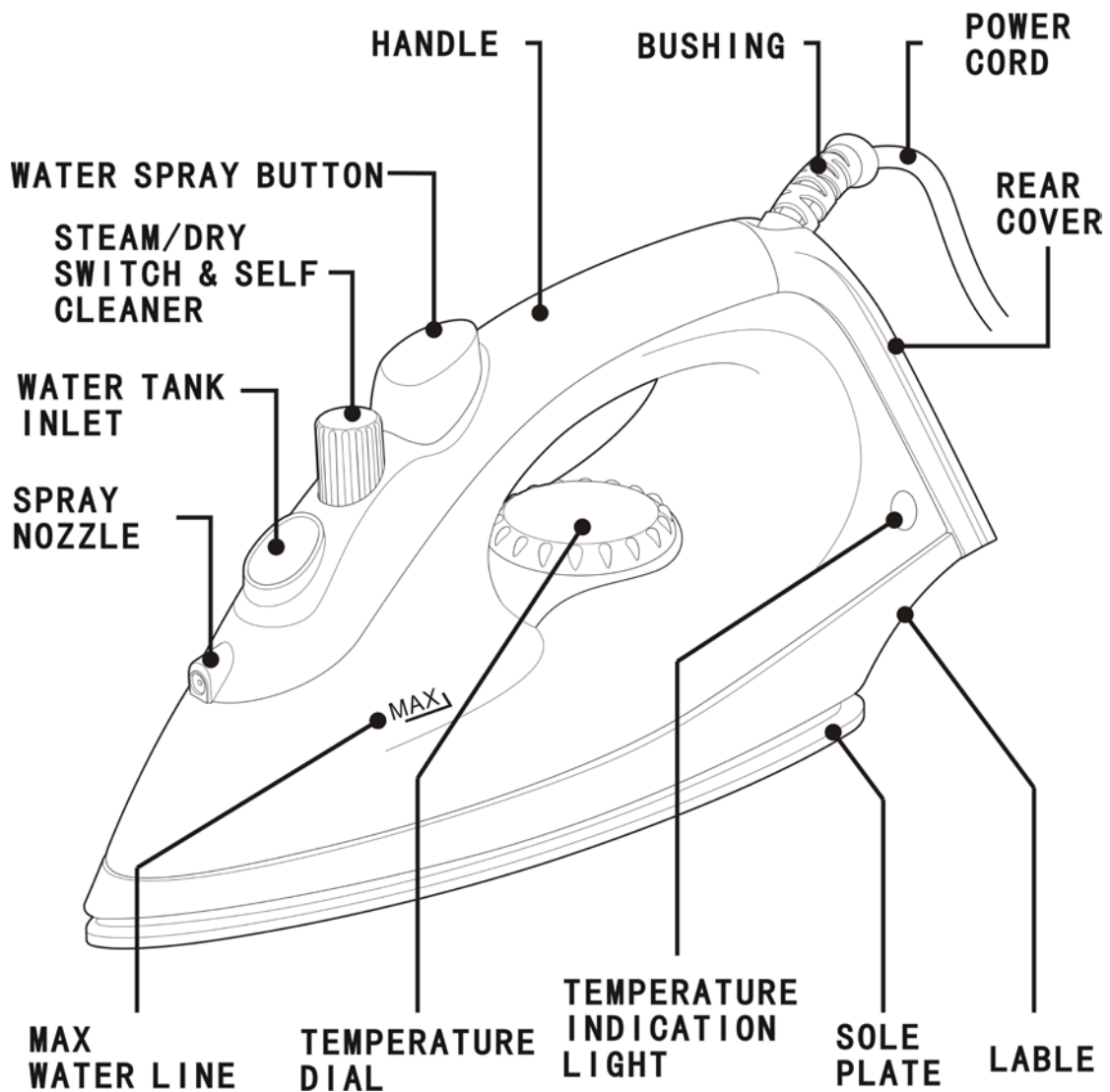

## Important Instructions

Please read the instructions carefully before operation and retain for future reference.

1. Make sure that the voltage of your steam iron is in accordance with the voltage of your power system (230V~60Hz).
2. Keep away from children when using the steam iron.

3. Do not immerse the iron into water.
4. Keep the cord away from the soleplate.
5. Before storing the iron, please try to let the iron cool down completely.
6. Always keep the instruction manual. In case the iron is passed to a third person, please hand over the manual together.
7. If the supply cord is damaged, it must be replaced by the manufacturer or its service agent or a similarly qualified person in order to avoid a hazard.
8. Note: For the new steam iron during first use, some parts have been slightly greased, thus smoke will rise. This will stop after a new minutes.
9. This appliance is not intended for use by persons (including children) with reduced physical, sensory or mental capabilities, or lack of experience and knowledge, unless they have been given supervision or instruction concerning use of the appliance by a person responsible for their safety
10. Children should be supervised to ensure that they do not play with the appliance.
11. The user must not leave the iron unattended while connected to the supply
12. The plug of the supply cord must be removed from the socket-outlet before the water reservoir is filled with water
13. The iron shall be used on a stable ironing board
14. The iron must be used and rested on a stable surface.
15. When placing the iron on its stand, ensure that the surface on which the stand is placed is stable.
16. The iron is not to used if it has been dropped, if there are visible signs of damage or if it is leaking.
17. The iron shall not be used if the iron has been dropped at any time, or if there are visible signs of damage or if the iron is leaking. The iron shall be sent to the manufacturer or his qualified service agent before further use

## **Use**

Remove the protection film from the soleplate before first use.

You can use your iron with usual tap-water. To increase the steam iron's life span, it is advised to select the hard water with more than 17° dH, distilled water or demineralized water.

## **Fill in water tank**

Unplug the appliance and screw the temperature control to position "0"(min.)

Fill water to the MAX level on the tank.

## **Temperature control**

Put the steam iron upright and select the desired temperature with the temperature control. Pay attention to the symbols on the knob for the different textiles:

- chemical fibres/synthetic
- nature fibres/silk/wool
- nature fibres/cotton/linen

## Functions

### Water spray

To dampen laundry: press the button of "water spray".

### Dry/ Steam

You can fix the steam intensity by turning the steam function.

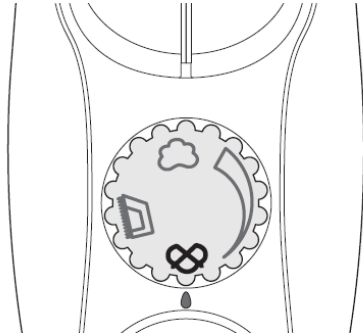

To iron without steam, rotate the Steam/Dry Switch to the dry setting ∞.

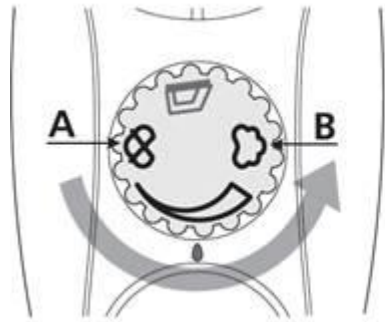

The amount of steam produced is regulated by the Steam/Dry switch.

**A** - No steam, twist anti-clockwise to increase the steam until you reach **B** - high steam.

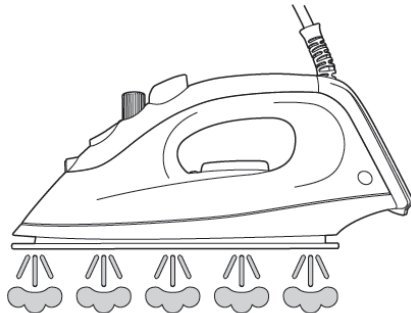

**2. Important:** The iron gives off continuous steam when in the horizontal position only.

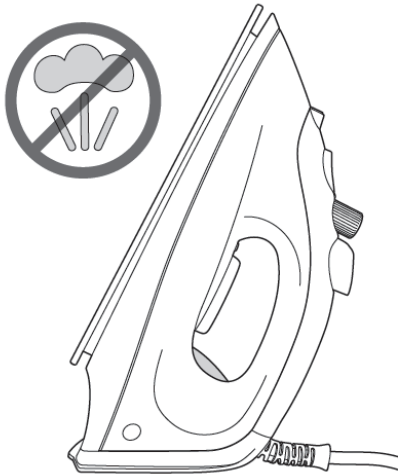

3. The steam will stop once the iron is placed in the vertical position.

### Keeping/Cleaning/Care

Switch the steam iron off (Put the knob to the minimum position) and unplug. Put the steam iron upright and let it completely cool down, empty the water tank.

Remove the residues from the soleplate with a vinegar-water solution. Rub the cabinet with a moist cloth and finally rub it dry.

### Automatic electricity interruption for security

In case the installed thermostat gets out of order, the power supply will stop automatically to avoid the steam iron overheating. I.

### Self Cleaning

The self clean feature cleans the inside of the iron and removes impurities. This is recommended every 10 to 15 days.

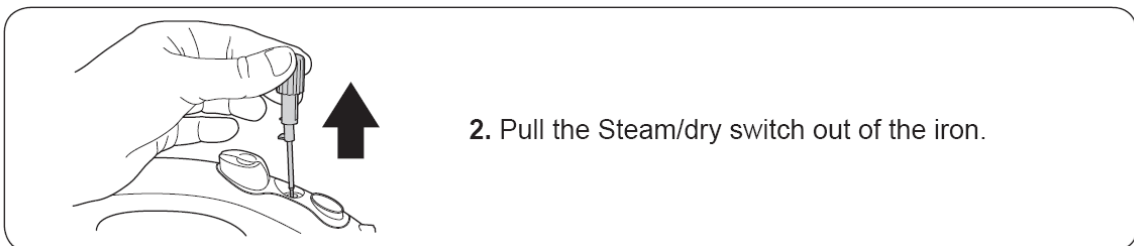
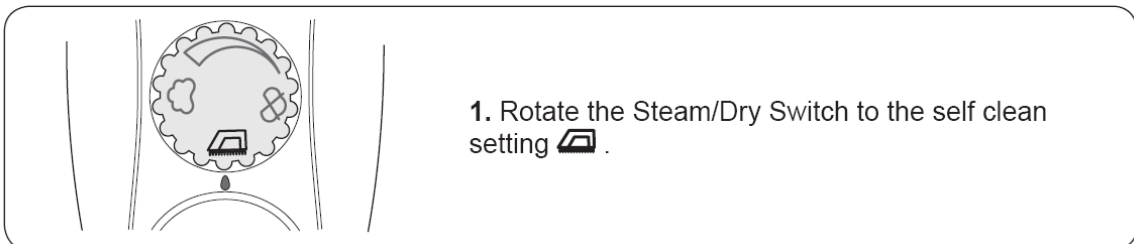

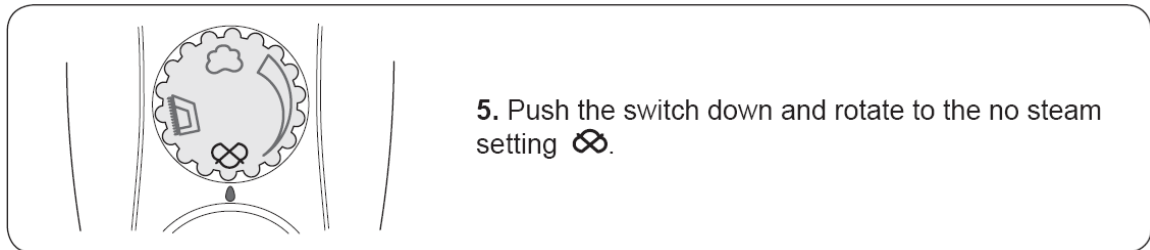
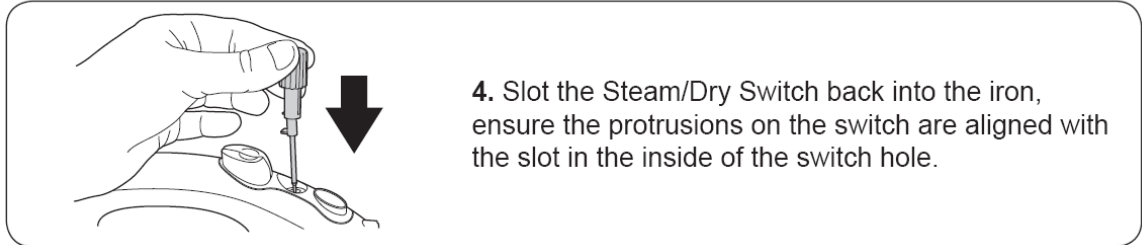
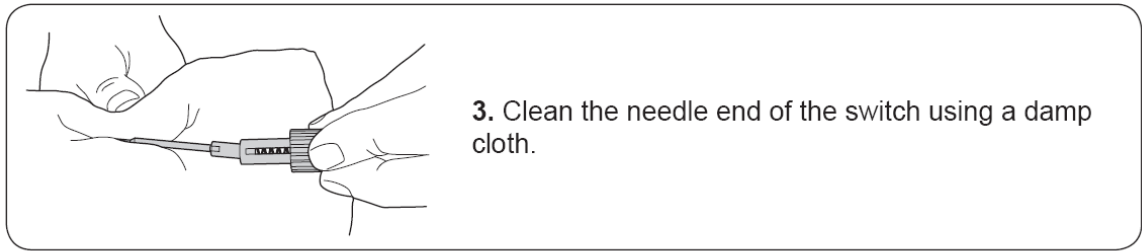

### How to store

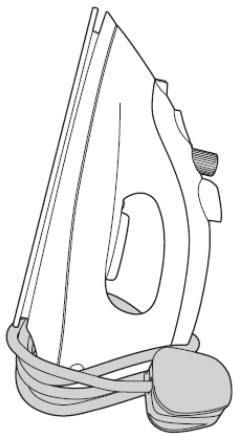

Before storing the iron, pull the plug out of the socket and leave the iron to cool.

Empty the water tank by turning the iron upside down and shaking all of the water out.

Wrap the power cord around the iron as shown. Store the iron in a vertical position.

Correct Disposal of this product	
	<p>This marking indicates that this product should not be disposed with other household wastes throughout the EU. To prevent possible harm to the environment or human health from uncontrolled waste disposal, recycle it responsibly to promote the sustainable reuse of material resources. To return your used device, please use the return and collection systems or contact the retailer where the product was purchased. They can take this product for environmental safe recycling.</p>